

## M23 Straight Connector, Panel Mount, Crimp, Front fastened, Coupling screw

Male

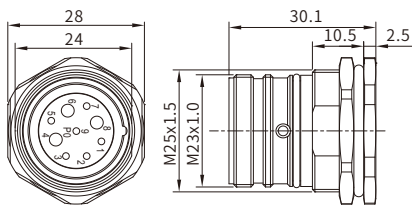

Female

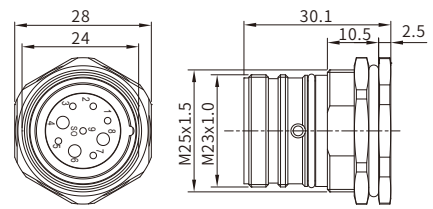

### Specifications

Contacts	6A	7A	9A	9B	9C	12A	12B	16A	17A	17B	19A
Certification	ECBT2(ECBT8).E473386										
Pin layout(Male)											
Pin layout(Female)											
Connector insert	PA										
Connector contacts	Brass with gold plated										
Coupling nut/screw	Brass with nickel plated										
Seal/O-ring	FKM or NBR										
Mating Endurance	>800										
Insulation resistance	≥100MΩ										
Contact resistance	≤5mΩ										
Ambient temperature	-40°C ~ +125°C										
Shielding	Unavailable										
IP rating	IP67, IP68 in locked condition										
Panel cut-out	Refer to page 482										
Number of positions	6,7		9(8+1)/(6+3)				12	16		17	19(16+3)
Contacts	6,7		8 / 6		1 / 3		12	16		17	16 3
Contact OD(mm)	2.0(14AWG)		1.0(18AWG)		2.0(14AWG)		1.0(18AWG)		1.0(18AWG)		1.0(18AWG) 1.5(16AWG)
Rated current @ 20°C(A)	20		8		20		8		8		8 10
Rated Voltage(V)	300		300		300		300		160		160 160
Impulse voltage(V)	2500		2500		2500		1500		1500		1500 1500
Overtoltage category	II										
Pollution Degree	III										

### Part Number

Note: SX refer to panel mount hole S1:PG13.5; S2:M25x1.0; S3:M25x1.5

Pins	Male	Female
6A	M23-SSCPSTFS <sub>SX</sub> 06A	M23-SSCSSTFS <sub>SX</sub> 06A
7A	M23-SSCPSTFS <sub>SX</sub> 07A	M23-SSCSSTFS <sub>SX</sub> 07A
9A	M23-SSCPSTFS <sub>SX</sub> 09A	M23-SSCSSTFS <sub>SX</sub> 09A
9B	M23-SSCPSTFS <sub>SX</sub> 09B	M23-SSCSSTFS <sub>SX</sub> 09B
9C	M23-SSCPSTFS <sub>SX</sub> 09C	M23-SSCSSTFS <sub>SX</sub> 09C
12A	M23-SSCPSTFS <sub>SX</sub> 12A	M23-SSCSSTFS <sub>SX</sub> 12A
12B	M23-SSCPSTFS <sub>SX</sub> 12B	M23-SSCSSTFS <sub>SX</sub> 12B
16A	M23-SSCPSTFS <sub>SX</sub> 16A	M23-SSCSSTFS <sub>SX</sub> 16A
17A	M23-SSCPSTFS <sub>SX</sub> 17A	M23-SSCSSTFS <sub>SX</sub> 17A
17B	M23-SSCPSTFS <sub>SX</sub> 17B	M23-SSCSSTFS <sub>SX</sub> 17B
19A	M23-SSCPSTFS <sub>SX</sub> 19A	M23-SSCSSTFS <sub>SX</sub> 19A