

Product data sheet

SPE Cables & Connectors



<https://finecables.com/spe-pcb-panel-mount/365/>

Product description	M8 2P Female Straight Connector, PCB Panel Mount, Rear fastened, Contacts: 2, Shielded, IP67
Part no.	SPEB08FBSHDR02ST

Illustration



Scale drawing

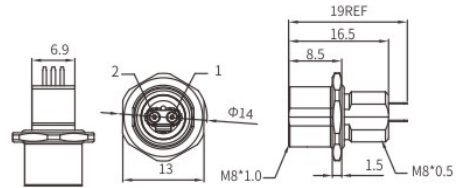

You can find the assembly instructions on the next page.

General features

Part no.	SPEB08FBSHDR02ST
Standard	IEC 63171-6-2021
Ambient temperature	-40°C ~ +80°C
IP rating	IP67
Mating endurance	>500 cycles
Insertion/withdrawal force	50N Max.

Electrical parameters

Insulation resistance	≥500 MΩ
Contact resistance	≤20 mΩ
Shielding	Available
Rated current	4A
Rated voltage	60V D / C

Material

Connector insert	PA
------------------	----

Product data sheet
SPE Cables & Connectors



<https://finecables.com/spe-pcb-panel-mount/365/>

Product description	M8 2P Female Straight Connector, PCB Panel Mount, Rear fastened, Contacts: 2, Shielded, IP67
Part no.	SPEB08FBSHDR02ST
Connector contacts	Brass with gold plated
Connector body	Zinc alloy

Security Notices

The connector must not be plugged or unplugged under load. Non-observance and improper use can result in personal injury.

The connectors have been developed for applications in plant engineering, control and electrical equipment construction. The user is responsible for checking whether the connectors can also be used in other areas of application.

Connectors which are used in circuits with voltages dangerous to the touch may only be installed and used by, or under the supervision of, persons with electrical engineering training, taking into account the applicable regulations and standards.

The user must take suitable safety precautions to ensure that the connector cannot be accidentally disconnected.

Please observe the pollution degree and the overvoltage category. For further information, please refer to the download center "Technical Information".

Finecables Enterprise Co., Ltd

Email: info@finecables.com

Web: www.finecables.com

Tel: +86 0769-81517898

Address: No.54 Changdi Road, Nanmian Community Humen Town Dongguan City, Guangdong Province, China.