

RD24 A-coding Straight Connector, Field Wirable Assembly, Solder

Male

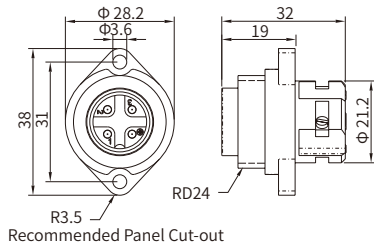

CE RoHS

Female

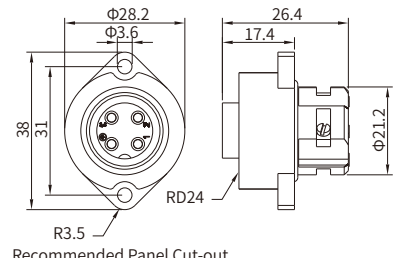

CE RoHS

Specifications

Contacts	1+PE	2+PE	3+PE
Certification	ECBT2(ECBT8).E473386		
Pin layout(Male)			
Pin layout(Female)			
Ambient temperature	-25°C ~ +125°C		
Connector insert	PBT		
Connector contacts	Brass with gold plated		
Coupling nut/screw	PBT		
Seal/O-ring	Epoxy resin / EPDM		
Termination type	Screw		
Insulation resistance	≥100MΩ		
Contact resistance	≤5mΩ		
Shielding	Unavailable		
Suitable cable Dia	PG9: 6~8mm		
IP rating	IP67, IP68 in locked condition		
Mating endurance	>500 cycles		
Rated current	12A		
Rated voltage	600V AC / DC		
Wire gauge	0.75mm ² (AWG18~14)		

Part Number

Pins	Male	Female
1+PE	MA24MWAFP1+1ST	MA24FWAFP1+1ST
2+PE	MA24MWAFP2+1ST	MA24FWAFP2+1ST
3+PE	MA24MWAFP3+1ST	MA24FWAFP3+1ST

Panel Cut-out Dimensions

